

STEAM SEPERATORS

SPR-16/25/40

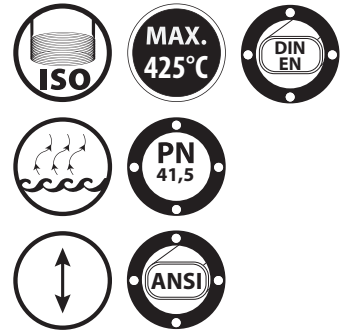

Scan this QR Code



DESIGN

Product Features		Operating Conditions	
Body	Carbon Steel Stainless Steel (Optional)	Max. Operating Pressure (PMO)	16/25/40
Internals	Stainless Steel AISI 304	Max. Operating Temp. (TMO)	200°C
Connections	Flanged		

Operation

Steam separators, as their name implies, separate steam from entrained condensate, or "dry" the steam. They are most often used in front of equipment that requires especially dry steam, such as platen presses or autoclaves. They are also common on secondary steam lines where condensate has been collected and "flashed" into steam at a lower pressure. Flash steam, by nature, has a high entrained condensate content.

Installation

The SPR 16-25-40 Steam Separator must be installed in a vertical position as the system connection to be underneath.

HOW TO USE THE DIAGRAM

- Draw A-D line for the steam pressure of 10 bar and the mass flow of 1000 kg/h.
- Extend A-B line horizontally.
- Any separator is intersecting with the A-b line in the blue area would work with approximately 100% efficiency.
- Flow rate is determined by vertical line of B-C line (19 m/s.)
- Pressure drop is detected with intersecting the lines of A-B and C-D.
- Separator should be selected in the accordance with line diameter, velocity and pressure drop.

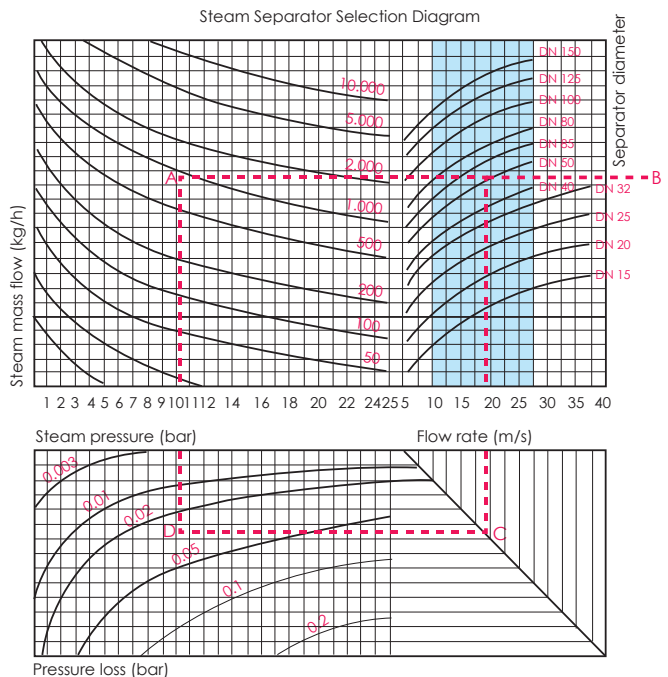

STEAM SEPERATORS

SPR-16/25/40

Construction

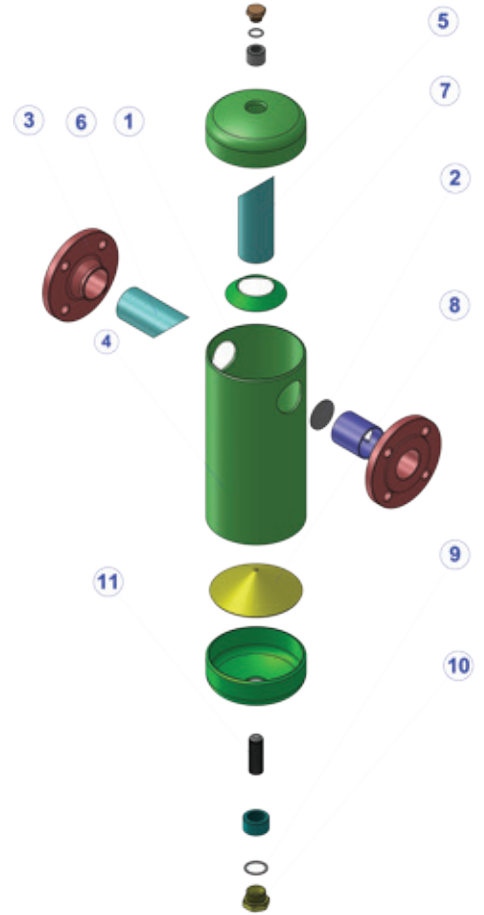
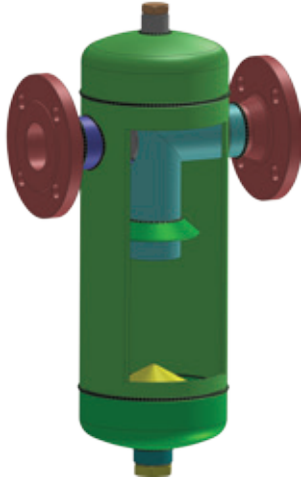

Part list		
No	Part Name	Material
1	Intermediate Pipe	Carbon Steel
2	Metal Cover	Carbon Steel
3	Flange	Carbon Steel C22.8
4	Body (Seamless Tube)	Carbon Steel
5	Spreader-Gathering Conical Cyclone	Carbon Steel
6	Filter Pipe	Carbon Steel
7	Special Particle holder filter	Stainless Steel AISI 304
8	Liquid-Gaseous seperator plate	Stainless Steel AISI 304
9	Gasket	Brass
10	Filter Cleaning Cork	Carbon Steel C22.8
11	Steam Trap Protection Filter	Stainless Steel AISI 304

Dimensions

Size		Dimensions					Code PN 16	Code PN 25	Code PN 40
		Threaded							
		H (mm)	L (mm)	M (mm)	ØI (mm)	ØF (mm)			
DN 15	1/2"	356	180	88,9	95	48,3	708400000415	708400100424	708400200415
DN 20	1/2"x1/2"	411	230	114,3	105	60,3	708400000420	708400100430	708400200420
DN 25	1/2"x1/2"	427	230	114,3	115	76,1	708400000425	708400100432	708400200425
DN 32	1/2"x1/2"	440	250	139,7	140	88,9	708400000432	708400100433	708400200432
DN 40	1/2"x1/2"	486	300	168,3	150	114,3	708400000436	708400100434	708400200436
DN 50	1/2"x1/2"	540	300	168,3	165	114,3	708400000440	708400100436	708400200440
DN 65	1/2"x3/4"	645	400	219,1	185	139,7	708400000444	708400100440	708400200444
DN 80	1/2"x3/4"	724	450	273	200	168,3	708400000448	708400100444	708400200448
DN 100	1/2"x1"	795	500	323,9	235	219,1	708400000452	708400100448	708400200450
DN 125	1/2"x1"	965	600	355,6	250	273	708400000450	708400100452	708400200452
DN 150	1/2"x1"	1175	600	406,4	285	323,8	708400000454	708400100456	708400200454

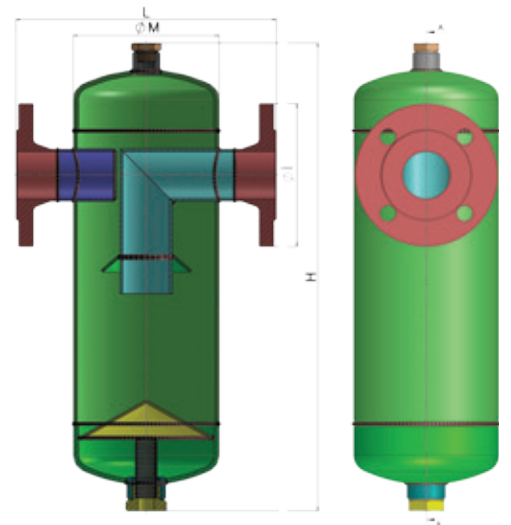

All the dimensions in the table are given in "mm".

Subject to technical alterations and deviations resulting from the manufacturing process without giving any notification.